

## F1

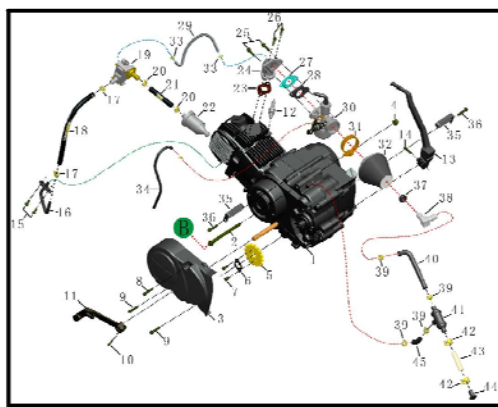

SECTION 1 发动机和化油器总成 ENGINE AND CARBURETOR ASSY.

REF.No.	PART No.	DESCRIPTION	QTY
S1-1	ZW110JZFW415B02B	engine, 110cc, kick start, automatic clutch	1
		engine, 125cc, kick start, automatic clutch	1
S1-2	G16674M8115125G	bolt, flanged M8*115	1
S1-3	12306-F004-280089	engine cover, left crankcase	1
S1-4	G6187M8G	nut, flanged, locking M8	1
S1-5	23401-G011-0008	engine sprocket	1
S1-6	23402-D002-0000	locking washer, sprocket	1
S1-7	B057830006001070B	bolt M6*10	2
S1-8	B166740A06003570X	bolt, flanged M6*35	1
S1-9	B166740A06003270X	bolt-flanged M6*32	2
S1-10	B057830006002070X	bolt M6*20	1
S1-11	Y325402D01	lever, gear shift	1
S1-12	81300-G011-0005	spark plug, NGK	1
S1-13	FR10005701B01	kick starter lever	1
S1-14	G701M625G	bolt M6*25	1
S1-15	G16674M612G	bolt, flanged M6*12	2
S1-16.....22	Y21A7001a	actuator valve assy.	1
S1-16		secondary air inlet pipe	1
S1-17		hose clamp	2
S1-18		air inlet hose	1
S1-19		air actuator valve	1
S1-20		clamp	2
S1-21		hose	1
S1-22		actuator valve filter	1
S1-23	15810-G001-0000	gasket, air intake	1
S1-24	FR1000630001G	intake pipe	1
S1-25	B057830006003070X	bolt M6*30	2
S1-26	B057830006002570X	bolt M6*25	1
S1-27		paper gasket, carburetor	1
S1-28	90214-G011-0000	spacer, (composite plastic)	1
S1-29		hose	1
S1-30	Y80A5801	carburetor PZ22	1
S1-31		braket	1
S1-32	FR10005901B01	air filter, steel cone	1
S1-32		air filter, sponge	1
S1-33	Y373617G03	clamp, hose Φ8	3
S1-34		fuel hose	1
S1-35	Y80210021B01	bracket, brake hose	1
S1-36	B057830006003570X	bolt, M6*35	1
S1-37	Y31340033B01	gromment	1
S1-38	Y33590117B01	connect pipe, air filter	1
S1-39.....44	12130-G011-1500	air/oil seperator Assy.	1

# F2

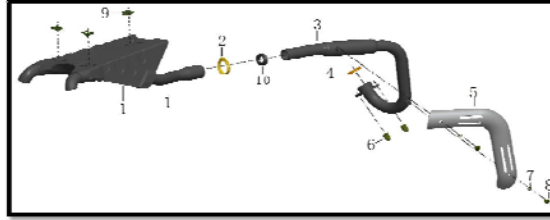

消音器总成 EXHAUST ASSY. SECTION 2

REF.No.	PART No.	DESCRIPTION	QTY
S2-1	FR10006203B01	muffler	1
S2-2		braket	1
S2-3	FR10006201B01	exhaust pipe, with catalyst	1
S2-4	Y80620004	seal, exhaust	1
S2-5		anti-heat cover, exhaust pipe	1
S2-6	Y80370009G02	bolt M6*21	2
S2-7		lock washer	2
S2-8		bolt M6*21	2
S2-9	Y37370014G02	nut clip M6	3
S2-10		exhaust seal	1

# F3

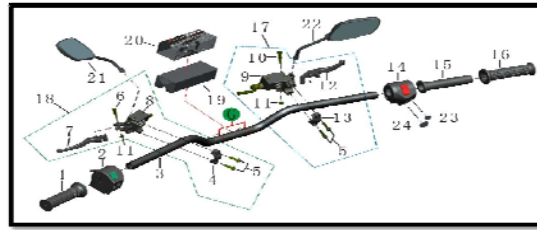

方向把总成 HANDLEBAR ASSY. SECTION 3

REF.No.	PART No.	DESCRIPTION	QTY
S3-1	Y33110010B01	grip, LH	1
S3-2	Y377901	switch, control, LH	1
S3-3	Y37110002B01	handel bar, tapered	1
S3-4		mater cylinder bracket	1
S3-5		bolt	4
S3-6		bolt	1
S3-7	FR1000290101	brake lever, rear brake	1
S3-8	FR1000290103B01	master cylinder, rear	1
S3-9	FR1000170103B01	master cylinder	1
S3-10		bolt	1
S3-11		nut	2
S3-12	FR1000170101	brake lever	1
S3-13		mater cylinder bracket	1
S3-14	Y377902	switch, control, RH	1
S3-15...16	Y33110011B01	grip, RH	1
S3-15			1
S3-16			1
S3-17	FR1000170103B01	master cylinder set,	1
S3-18	FR1000290103B01	master cylinder, rear	1
S3-19	Y31110007aB01	foam padding,	1
S3-20	ZS-XBUS11-FR1000-B01	foam pad cover	1
S3-21		mirror, left	1
S3-22		mirror, right	1
S3-23	Y33340043B01	cover, end cap, switch, control, RH, top	1
S3-24	Y33340043aB01	cover, end cap, switch, control, RH, bottom	1

# F4

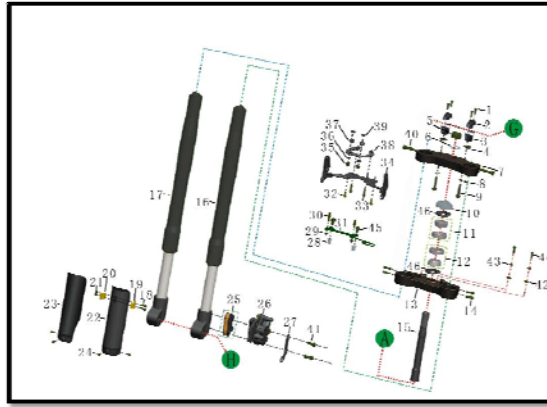

前叉总成 FORK ASSY., FRONT . SECTION 4

REF.No.	PART No.	DESCRIPTION	QTY
S4-1	G701M825125G	bolt M8*25*1.25	4
S4-2	Y36130002B01C	riser, handle bar, top	1
S4-3	Y36130001B01C	riser, handle bar, bottom	1
S4-4	G96F10G	flat washer Φ10	2
S4-5	Y31370009D01	cap nut, steering stem M22	1
S4-6	Y31370002W02	flat washer Φ22.5*Φ36*0.6	1
S4-7	FR1000130003B01	triple clamp, top	1
S4-8	G97F10G	flat washer Φ10	2
S4-9	G16674M1050125GJ	Bolt, M10*50*1.25	2
S4-10	Y80370016W02	steering stem lock nut	1
S4-11	G297Y32005X	bearing 32005X	1
S4-12	G297Y32005X	bearing 32005X	1
S4-13	FR1000130005B01	triple clamp, bottom	1
S4-14	G701M625W	nut	4
S4-15	Y30130007L	steering stem Φ25*M22*231mm	1
S4-16...17	FR10001402B01	front fork, non-adj. T6	1
S4-16	FR10001402B01	front fork, left, non-adj. T6	1
S4-17		front fork, right, non-adj. T6	1
S4-18	G702M616G	bolt, M6*16	2
S4-19...20	Y31360005S01	bracket, brake hose, set	1
S4-19			
S4-20			
S4-21	G889M5G	nut, locking M5	2
S4-22	Y31210002B01	guard, fork, LH (protector)	1
S4-23	Y31210003B01	guard, fork, RH (protector)	1
S4-24	Y37370006G02	bolt Φ10*4*M6*8	4
S4-25	FR1000170102	brake pads , with asbesto	1
S4-25		brake pads , without asbesto	
S4-26	FR1000170104B01	front brake caliper	1
		braket, front brake caliper	1
S4-27	Y38360018aB02B	bracket, speed sensor	1
S4-28	Y37360003hG02	spacer Φ6.5*Φ9*Φ13*12	2
S4-29	G6177M6G	nut, locking M6	2
S4-30	Y37370020G02	nut, front healight holder	2
S4-31	Y333603B03B	bracket, headlight, bottom	1
S4-32	G701M616G	bolt, M6*16	2
S4-33	G702M612G	bolt, M6*12	2
S4-34	Y333602B03B	bracket, headlight	1
S4-35	G6177M6G	nut, locking M6	2
S4-36	Y33B360003G02	washer, plate	2
S4-37	Y31340033B01	gromment	2
S4-38	FR10003601B02B	bracket, key ignition	1
S4-39	Y37360003aW02	spacer Φ6*Φ9*Φ24*5.5	2
S4-40	G701M825125W	nut	2
S4-41	G16674M830125G	bolt, flanged M8*30*1.25	2
S4-42	G97F8G	flat washer Φ8	2
S4-43	G93F8G	lock washer Φ8	2
S4-44	G701M820125G	bolt M8*20*1.25	2
S4-45	G16674M625G	bolt, flanged M6*25	2
S4-46	Y31370001	seal, dust, steering stem	2
		Front fork seal	1
		Front fork dust cover	1
		shim	1

# F5

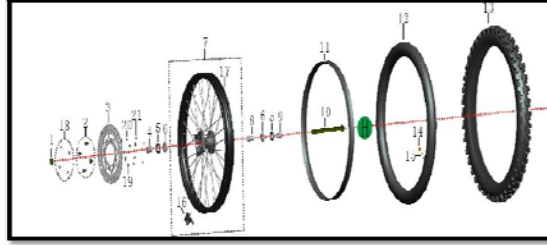

前轮总成 FRONT WHEEL ASSY. SECTION 5

REF.No.	PART No.	DESCRIPTION	QTY
S5-1	G6187M14150G	nut, flanged, locking M14	1
S5-2	Y80370006G02	bolt M8*16	4
S5-3	Y30170001	disc, brake, front $\Phi$ 210	1
S5-4	Y80280007aW02	spacer	1
S5-5	Y80A160103	seal, dust 35*22*6	2
S5-6	G276S6202RS	front rim bearing 6202	2
S5-7	FR10001602B01	rim assy. Front, 1.60*21"	1
S5-8	Y80A160305	spacer $\Phi$ 15.5* $\Phi$ 22*43	1
S5-9	Y80160007W02	spacer	1
S5-10	Y31160001G02	axle for front wheel $\Phi$ 15*M14*225	1
S5-11	Y37160004	inner tube protector band	1
S5-12	Y37160003	inner tube	1
S5-13	Y37160002	tire, front, YX, 21"	1
S5-14	Y37160005aB01	cap, air valve ( aluminum)	1
S5-15	G6170M8aW	nut	1
S5-16	Y37160006	rim lock	1
S5-17	FR1000160201B01	rim	1
S5-18	Y31860101	sensor, speed, (magnet)	4
S5-19	GT401A240261301	washer	4
S5-20	G955F8L	magnet, speed sensor	4
S5-21	G8941F74	bracket, sensor	4

# F6

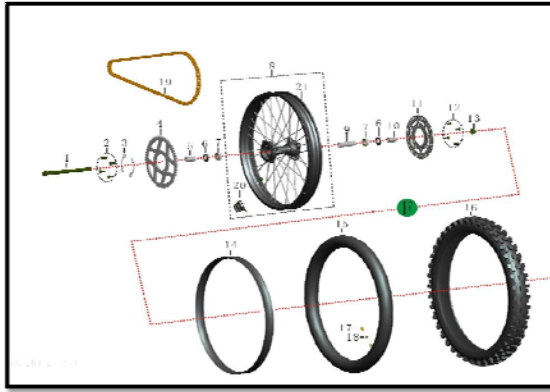

后轮总成 REAR WHEEL ASSY. SECTION 6

REF.No.	PART No.	DESCRIPTION	QTY
S6-1	FR1000160001G02	bolt, flanged M14*215	1
S6-2	G5783M825125G	bolt M8*25	4
S6-3	Y80360006W02	locking washer, sprocket	2
S6-4	FR100028001042851W02	sprocket, rear 428-51T/ Φ76*Φ92	1
S6-5	Y21D280008W02	spacer Φ15.5*Φ22*39.5	1
S6-6	Y80A160103	seal, dust 35*22*6	2
S6-7	G276S6202RS	front rim bearing 6202	2
S6-8	FR10002802B01	rim, rear assy. 1.60*21"	1
S6-9	Y80A280305	spacer Φ17*Φ20*73	1
S6-10	Y30280007W02	spacer Φ15.5*Φ22*28.5	1
S6-11	Y80C290001	disc, brake, rear Φ200	1
S6-12	Y80370006G02	bolt M8*16	4
S6-13	G6187M14150G	nut, flanged, locking M14	1
S6-14	Y37160004	inner tube protector band	1
S6-15	Y37160003	inner tube	1
S6-16	Y37160002	tire, front, YX, 21"	1
S6-17	Y37160005aB01	cap, air valve ( aluminum)	1
S6-18	G6170M8aW	nut	1
S6-19	G14212L428118J01	chain 428-118L	1
S6-20	Y37160006	rim lock	1
S6-21	FR1000160201B01	rim	1

# F7

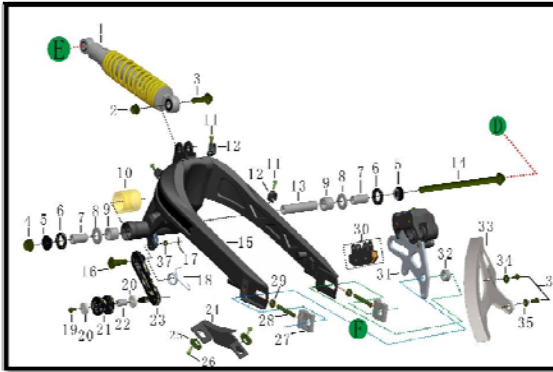

后平叉总成 REAR SWING ARM ASSY. SECTION 7

REF.No.	PART No.	DESCRIPTION	QTY
S7-1	FR10002701G03	rear shock, non-adj.	1
S7-2	G6187M10125G	nut, flanged, locking M10	1
S7-3	G16674M1040125GJ	bolt, flanged M10*40	1
S7-4	G6187M12125G	nut, flanged, locking M12	1
S7-5	Y31260002G02	spacer $\Phi 12.2 \times \Phi 20 \times \Phi 28 \times 10$	2
S7-6	G9877F20325	seal, dust 20*32*5	2
S7-7	Y30260003	spacer $\Phi 12.1 \times \Phi 17 \times 35$	2
S7-8	G4663TAXK1730	bearing 17*30*4	2
S7-9	G5801GNK1720	bearing NK17/20	2
S7-10	FR1000340002B01	guide, chain $\Phi 32 \times \Phi 42 \times 45$	1
S7-11	G819M612G	bolt M6*12	3
S7-12	Y31210021B01	bracket, brake hose	3
S7-13	Y31260003L	spacer $\Phi 12.5 \times \Phi 18 \times 94.5$	1
S7-14	FR1000260001G02	axle	1
S7-15	FR10002604B03B	swing arm, rear	1
S7-16	Y33B370010G02	bolt M10*20	1
S7-17	G91F225G	cotter pin $\Phi 2$	1
S7-18	FR1000360037W02	spring,, chain tensioner	1
S7-19	G16674M635G	bolt, flanged M6*25	1
S7-20.....22	Y80260015R01	chain roller	2
S7-23	FR1000260016B03B	bracket, roller, guide, chain,assy.	1
S7-24	FR1000340002aB01	chain guide, swing arm	1
S7-25	G819M612G	bolt M6*12	2
S7-26	Y37370007G02	washer, oval	2
S7-27	Y31260018B01	adjuster, wheel	2
S7-28	Y37370013aG02	bolt, adjuster	2
S7-29	Y37370012G02	nut M8	2
S7-30	FR1000290102	brake pads	1
		brake pads, no asbesto	
S7-31	FR1000290002B01	bracket, brake, rear 2	1
S7-32	Y30280008W02	spacer $\Phi 15.5 \times \Phi 22 \times 15$	1
S7-33	Y37210024B01	guard , disc brake, rear (protector)	1
S7-34	G97F6G	flat washer $\Phi 6$	1
S7-35	Y37360003bG02	spacer $\Phi 7 \times \Phi 12.5 \times \Phi 18 \times 5.2$	1
S7-36	G16674M610G	bolt, flanged M6*10	2
S7-37	G97F8G	flat washer $\Phi 8$	1

# F8

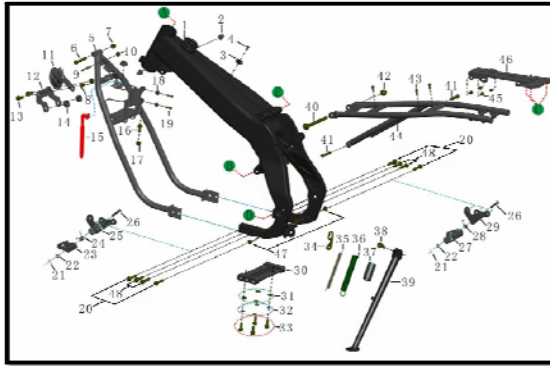

车架和车尾架总成 FRAME AND SUB-FRAME . SECTION 8

REF.No.	PART No.	DESCRIPTION	QTY
S8-1	FR10001801B03B	frame	1
S8-2	Y338003B01	bracket, wiring harness	1
S8-3	Y37210020B01	bracket, seat	1
S8-4	G819M616G	bolt	1
S8-5	FR10001810B03B	engine cradle, bottom	1
S8-6	G16674M860125G	bolt	1
S8-7	G6187M8G	nut, flanged, locking M8	1
S8-8	G6187M6G	nut, flanged, locking M6	2
S8-9	G16674M612G	bolt, flanged M6*12	1
S8-10	G6187M6G	nut, flanged, locking M6	1
S8-11	Y377501B01	horn	1
S8-12	FR1000360033B02B	battery bracket	1
S8-13	G16674M612G	bolt, flanged M6*12	2
S8-14	Y37340030B01	pads, rubber, number plate,	3
S8-15	Y37340026	battery sling	1
S8-16	G16674M625G	bolt, flanged M6*25	1
S8-17	G6187M6G	nut, flanged, locking M6	1
S8-18	G6187M6G	nut, flanged, locking M6	2
S8-19	G16674M612G	bolt, flanged M6*12	2
S8-20	G16674M845125G	bolt, flanged M8*45	4
S8-21	G91F225G	cotter pin Φ2	2
S8-22	G97F8G	flat washer Φ8	2
S8-23	Y33B240001B04B	foot rest, LH	1
S8-24	Y37360037W02	spring, foot rest, LH	1
S8-25	FR1000240003B03B	bracket, foot rest, LH	1
S8-26	G882F843G	pin, rod Φ8*43	2
S8-27	Y33B240002B04B	foot rest, RH	1
S8-28	Y37360038W02	spring, foot rest, RH	1
S8-29	FR1000240004B03B	bracket, foot rest, RH	1
S8-30	Y321803B03B	bracket, engine, bottom	1
S8-31	G97F8G	flat washer Φ8	4
S8-32	G93F8G	lock washer Φ8	4
S8-33	G16674M820125G	bolt, flanged M8*20	4
S8-34	Y31230004W02	bracket, spring, kick stand	1
S8-35	Y37360002aW02	auxiliary kick stand spring	1
S8-36	Y37360002W02	main kick stand spring	1
S8-37	Y37340031	cover, spring	1
S8-38	Y31370011G02	bolt M10*25	1
S8-39	FR10002302aB03B	kick stand	1
S8-40	G16674M10125125GJ	bolt, flanged M10*125	1
S8-41	G701M820125G	bolt M8*20*1.25	2
S8-42	G6187M10125G	nut, flanged, locking M10	1
S8-43	G16674M612G	bolt, flanged M6*12	3
S8-44	FR10003001aB03B	sub-frame	1
S8-45	G16674M616G	bolt, flanged M6*16	4
S8-46	FR10003002B03B	bracket, rear light	1
S8-47	G6187M8G	nut, flanged, locking M8	2
S8-48	G16674M840125G	bolt, flanged M8*40*1.25	4



# F9

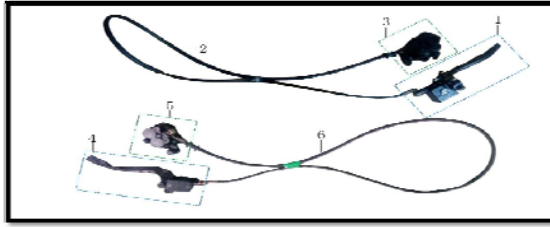

前后碟刹器总成 BRAKE ASSY.2, FT & RR . SECTION 9

REF.No.	PART No.	DESCRIPTION	QTY
ASSY.6	FR10001701aB01	brake assy., front	1
ASSY.7	FR10002901aB01	brake assy., rear	1
S9-1	FR1000170103B01	master cylinder, front	1
S9-2	FR1000170104B01	brake hose, front	1
S9-3	FR1000170106B01	hose, brake,front	1
S9-4	FR1000290103B01	master cylinder, rear	1
S9-5	FR1000290104B01	brake caliper, rear	1
S9-6	FR1000290106B01	hose, brake,rear	1
		Brake lever left switch	1
		Brake lever right switch	1

# F10

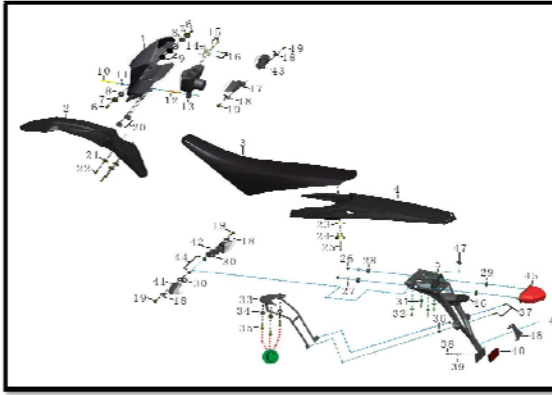

外罩总成/坐墊 FENDER AND SEAT ASSY. SECTION 10

REF.No.	PART No.	DESCRIPTION	QTY
S10-1	Y382001B01	headlight assy., front	1
S10-2	Y33150001B01	front fender	1
S10-3	FR10003201aB01	seat	1
S10-4	FR1000310001aB01	fender, rear	1
S10-5	Y37210016B01	bracket, license plate	1
S10-6	G16674M620G	bolt, flanged M6*20	2
S10-7	Y37360003aW02	spacer $\Phi 6^* \Phi 9^* \Phi 24^* 5.5$	2
S10-8	Y31340033B01	grommet	2
S10-9	Y33B360003G02	washer, plate	2
S10-10	G818M512G	bolt M5*15	1
S10-11	G97F5G	flat washer $\Phi 5$	1
S10-12		headlight adjusting bolt	1
S10-13	Y377701a	headlight, front	1
S10-14		bracket, headlight	1
S10-15	Y37370020G02	screw, headlight bracket	2
S10-16	G845ST3914G	bolt, ST3.9*14	2
S10-17	FR10007601	left turn signal, front	1
S10-18	Y333626B01A	bracket, turn signals	4
S10-19	G702M620G	bolt M6*20	4
S10-20	Y37340030B01	pads, rubber, number plate,	2
S10-21	Y37360003gG02	spacer $\Phi 7^* \Phi 9^* \Phi 15^* 4$	3
S10-22	G16674M616G	bolt, flanged M6*16	3
S10-23	FR1000370035S01	nut M12	1
S10-24	FR1000370036S01	Bolt, Seat, M12*11 $\phi$ 6.5 $\phi$ 19*18.5	1
S10-25	G701M625G	bolt M6*25	1
S10-26	G889M6G	nut, locking M6	2
S10-27	Y37360003aW02	spacer $\Phi 6^* \Phi 9^* \Phi 24^* 5.5$	2
S10-28	Y31340033B01	grommet	2
S10-29	Y33B360003G02	washer, plate	2
S10-30	Y33210036B01	spacer, turn signal, rear	2
S10-31	G97F6G	flat washer $\Phi 6$	4
S10-32	G845ST4216G	bolt ST4.8*14	4
S10-33	Y333625B03B	bracket, license plate (steel)	1
S10-34	G97F6G	flat washer $\Phi 6$	3
S10-35	G701M616G	bolt, M6*16	3
S10-36	G889M6G	nut, locking M6	2
S10-37	G16674M616G	bolt, flanged M6*16	2
S10-38	G889M5G	nut, locking M5	1
S10-39	G97F5G	flat washer $\Phi 5$	1
S10-40	Y378802	reflector, rear, red, EC approved	1
S10-41	FR10007603	left turn signal, rear	1
S10-42	FR10007604	right turn signal, rear	1
S10-43	Y317602a	turn signals, rear, RH	1
S10-44	G6187M6G	nut, flanged, locking M6	2
S10-45	Y338701	rear running light,	1
S10-46	Y378702	light housing assy., license plate	1
		light bulb, license light	1
S10-47	Y37340030B01	pads, rubber, number plate,	1
S10-48		bracket, triangular sign	1
S10-49	G12618F248	rivet	1

# F11

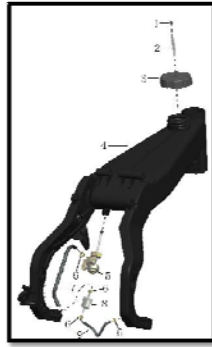

油箱总成 FUEL TANK ASSY. SECTION 11

REF.No.	PART No.	DESCRIPTION	QTY
S11-1	Y37210028B01	cap, breather hose	1
S11-2	Y37340010B01	breather hose	1
S11-3	FR10001902B01	fuel cap, plastics, FX1	1
S11-4	FR10001801B03B	frame	1
S11-5	FR10001903	fuel switch	1
S11-6	Y373617G03	clamp, hose Φ8	4
S11-7	Y80340011B01	hose, fuel 1	1
S11-8	Y371904a	gasoline filter	1
S11-9	Y80340011B01	hose, fuel 1	1

# F12

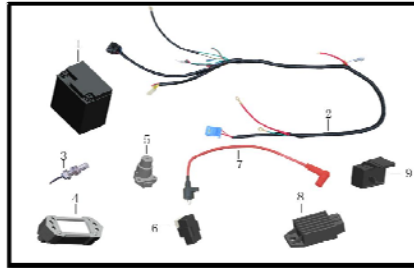

电零件 ELECTRICAL COMPONENTS . SECTION 12

REF.No.	PART No.	DESCRIPTION	QTY
S12-1	FR10008101	battery, motobatt 4.7Ah	1
S12-2	FR10008001c	wire harness, on road	1
S12-3	Y31A860101	sensor, speed	1
S12-4	FR10008601	speedometer, FX1	1
S12-5	Y37A780101	key ignition switch	1
S12-6	Y318401a	CDI	1
S12-7	Y808301R01	ignition coil	1
S12-8	Y338501a	voltage regulator	1
S12-9	Y338201	relay, flasher	1
	Y33800101	safety wire	1



拉索 CABLES . SECTION 13

REF.No.	PART No.	DESCRIPTION	QTY
S13-1	Y381202aB01	cable, throttle	1



随车工具 TOOL KIT . SECTION 14

REF.No.	PART No.	DESCRIPTION	QTY
S14-1	Y370401	tool kit	1

贴花 STICKER KIT . SECTION 15

REF.No.	PART No.	DESCRIPTION	QTY
S15-1	TH-XBUS11-FR1000-B03	STICKER	1